

PALM VIEW VILLA

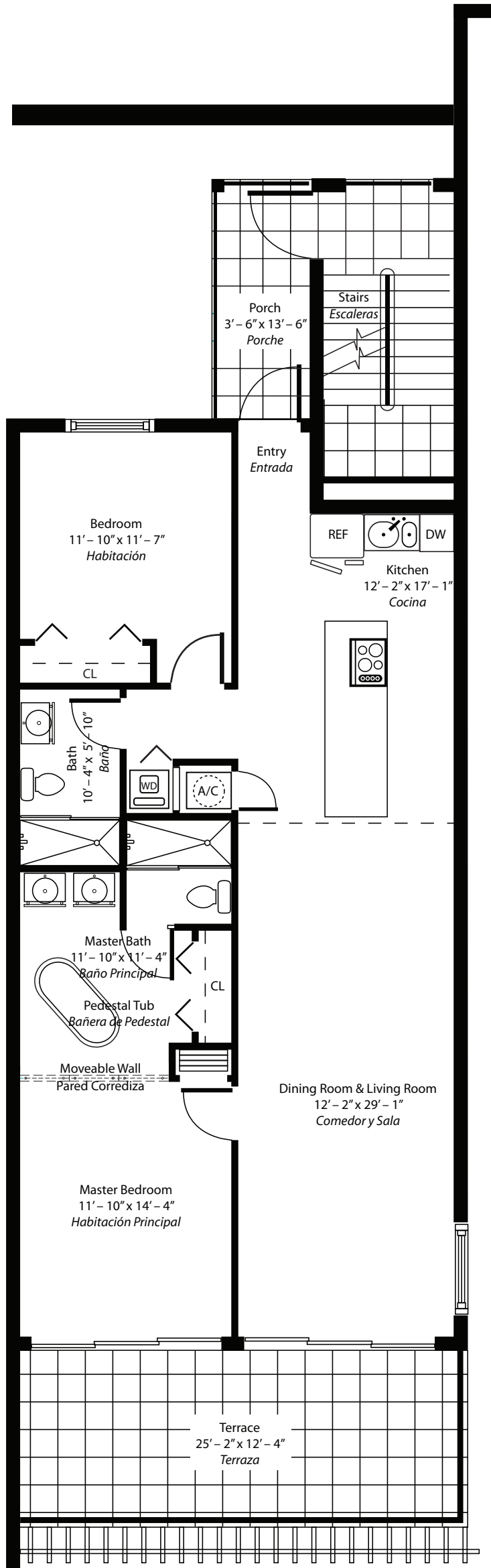

2 BEDROOMS • 2 BATHROOMS
2 HABITACIONES • 2 BAÑOS

INTERIOR	1,161 SQ FT	107 SQ MT
EXTERIOR	301 SQ FT	28 SQ MT
TOTAL	1,462 SQ FT	135 SQ MT

Las Terrazas
VILLAS & CONDOMINIUMS
THE NATURAL WAY OF LIFE

Prices, building design, specifications and features are subject to change without notice.
Precios de construcción, especificaciones y acabados están sujetos a cambios sin previo